

**BMM4-AF1080A/B, BMM4-AF4K8MPA/B/C Large FOV Auto Focus****Microscope**

BMM4-AF1080A/B &amp; BMM4-AF4K8MPA/B/C

**Introduction**

BMM4-AF1080A/B and BMM4-AF4K8MPA/B/C Large FOV Auto Focus Microscope have long working distance and large field of view, providing high resolution images and videos with 4K HDMI/ LAN/ USB 3.0 multi-interface output.

**Feature**

1. Sony Exmor/ Starvis back illuminated CMOS sensor.
2. 4K HDMI/ LAN/ USB 3.0 multi-interface output.
3. 4K/ 1080P HDMI 60fps output adaptive switching.
4. Images and videos are saved to USB flash drive, supporting local preview and playback.
5. Embedded software is used to control the camera, with built-in functions such as measurement and image comparison.
6. The USB 3.0 output resolution of video supports maximum YUV 4K20fps.
7. Support multiple control interfaces such as hard trigger, mouse, foot pedal, keypad, keyboard, etc.

**Specification**

Order Code	Sensor Size	Pixel (μm)	Shutter	Resolution	Frame Rate	Output Interface	Storage
<b>BMM4-AF1080A</b>	1/2.8"	2.9	Rolling	1920*1080	HDMI: 1080P@60fps LAN: 1080P@60fps	HDMI/ LAN	USB disk /PC
<b>BMM4-AF1080B</b>	1/2.8"	2.9	Rolling	1920*1080	HDMI: 1080P@60fps USB:1080P@60fps LAN: 1080P@60fps	HDMI/ LAN/ USB	PC
<b>BMM4-AF4K8MPA</b>	1/2.8"	1.45	Rolling	3840*2160	HDMI: 4K@30fps/ 1080P@30fps LAN:4K@30fps/ 1080P@30fps	HDMI/ LAN	USB disk /PC
<b>BMM4-AF4K8MPB</b>	1/2.8"	1.45	Rolling	3840*2160	HDMI: 4K@60fps LAN: 4K@30fps/ 1080P@60fps	HDMI/ LAN	USB disk /PC / RAM
<b>BMM4-AF4K8MPC</b>	1/2.8"	1.45	Rolling	3840*2160	HDMI: 4K@60fps USB: 4K@20fps/ 1080P@60fps LAN: 4K@30fps/ 1080P@60fps	HDMI/ LAN/ USB	PC

Order Code	Focusing	Sensor Type	Power Supply	Working Distance	Zoom Ratio	Digital Magnification
<b>BMM4-AF1080A</b>	Auto	CMOS	DC 12V	10cm~∞	1:14	1-6
<b>BMM4-AF1080B</b>	Auto	CMOS	DC 12V	10cm~∞	1:14	1-6
<b>BMM4-AF4K8MPA</b>	Auto	CMOS	DC 12V	10cm~∞	1:28	1-3
<b>BMM4-AF4K8MPB</b>	Auto	CMOS	DC 12V	10cm~∞	1:28	1-3
<b>BMM4-AF4K8MPC</b>	Auto	CMOS	DC 12V	10cm~∞	1:28	1-3

Optical Magnification	FOV (100mm working distance)	FOV (300mm working distance)
<b>1X</b>	171mm*92mm	420mm*230mm
<b>2X</b>	89mm*50mm	196mm*110mm
<b>5X</b>	71mm*40mm	150mm*84mm
<b>8X</b>	60mm*33mm	116mm*65mm
<b>10X</b>	52mm*29mm	101mm*57mm
<b>14X</b>	24.3mm*13.5mm	45.5mm*25mm
<b>28X</b>	12.15mm*6.75mm	22.75mm*13mm

## Interface

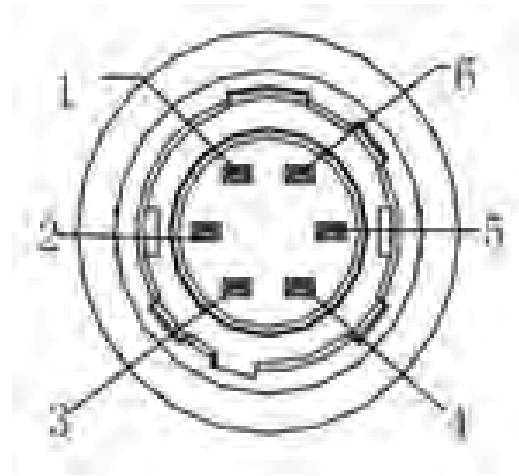

Trigger Serial No.	Function Symbol	Function Definition	Description
1	12V	IN	+12V DC power supply
2	Opt-Iso In	IN	Optocoupler isolation signal input
3	GPIO	IN/OUT	Can be configured as input or output
4	Opt-Iso Out	OUT	Optocoupler isolation signal output
5	I/O Ground	In	Signal ground
6	Gnd	In	Power ground

## Dimension

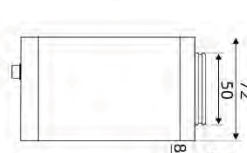
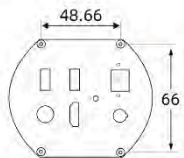
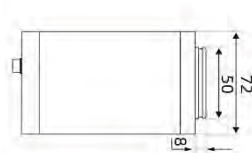
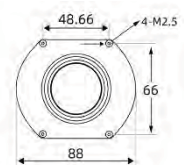
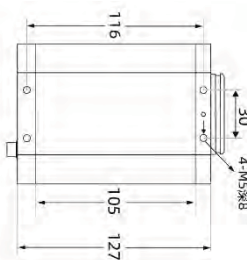
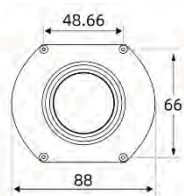
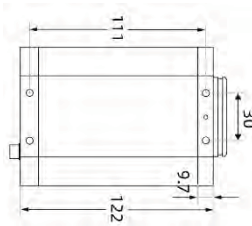

BMM4-AF1080A/B

BMM4-AF4K8MPA/B/C

Unit: mm